

# Installation manual for:

## CTKFD40C

### Ford Ranger



Installation kit includes the following items:

- 1x Replacement Panel
- 1x Switch Lead
- 1x Replacement Trim
- 1x Mini Speaker
- 1x Interface lead
- 1x Interface Box
- 1x Hazard Switch
- 1x Door lock Switch
- 2x Mounting Plates
- 4x Screws

**Note:** Phone Button Support Requires an Additional Interface - PACSWICP2 (Sold Separately)

# Installation Guide

Part No: CTKFD40C

Ford Ranger 2012>2015

Technical support provided by,

**stinger**  
australia

P: 03 9847 0177

E: solutions@stingeraustralia.com.au

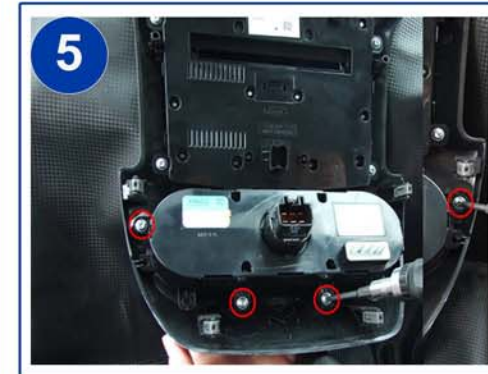
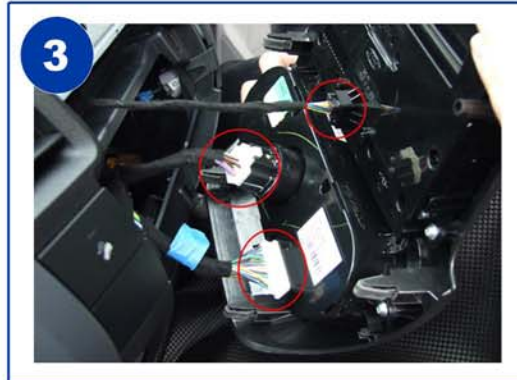

**1** Remove the OEM plastic fascia with plastic removal tools - use the lever tools in the highlighted area's.

**2** Once the fascia is unclipped, pull the fascia towards the rear of the vehicle

**3** Unplug the three OEM connectors from the back of the fascia

**4** Unscrew the two screws highlighted, then remove the head unit.

**5** Remove heater controls by removing the screws highlighted then fit the heater controls into the new fascia

**6** Remove the display by unscrewing the two screws on top of the display. Then unclip the display loom clips where highlighted

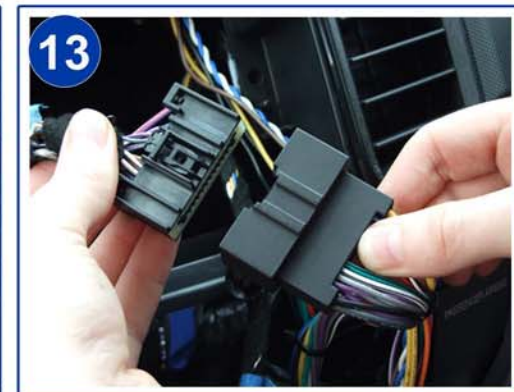
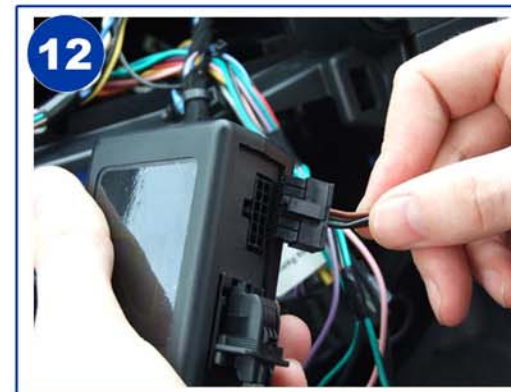
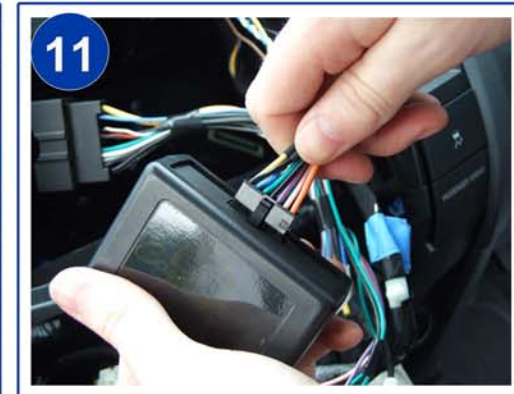

**7** Remove the OEM display connector

**8** Feed the Connects2 stalk display harness up through the dash - As shown in picture

**9** Connect the Connects2 stalk display connector into the OEM display and refit the display

**10** Plug the OEM display connector into the Connects2 interface box

**11** Plug the Stalk loom connector (14 Pin connector) into the interface box

**12** Plug the connects2 stereo patch lead into the interface

**13** Plug the main OEM connector into the Connects2 main connector



14

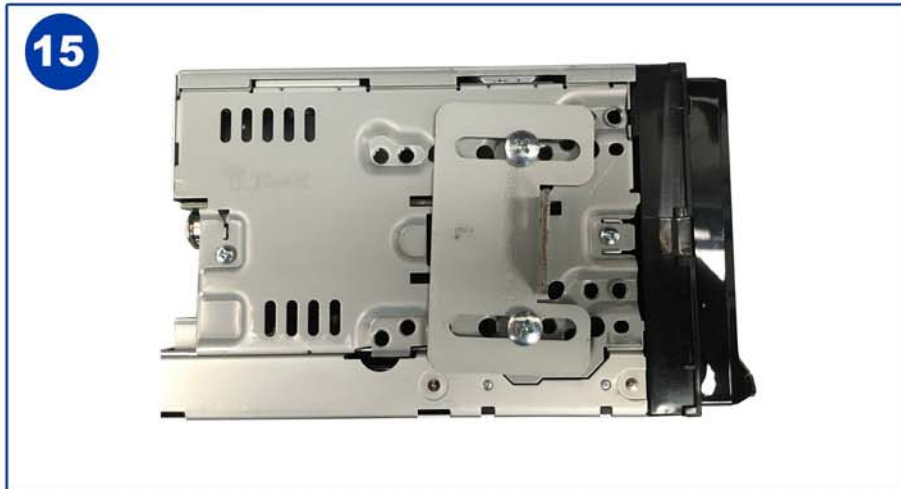

15

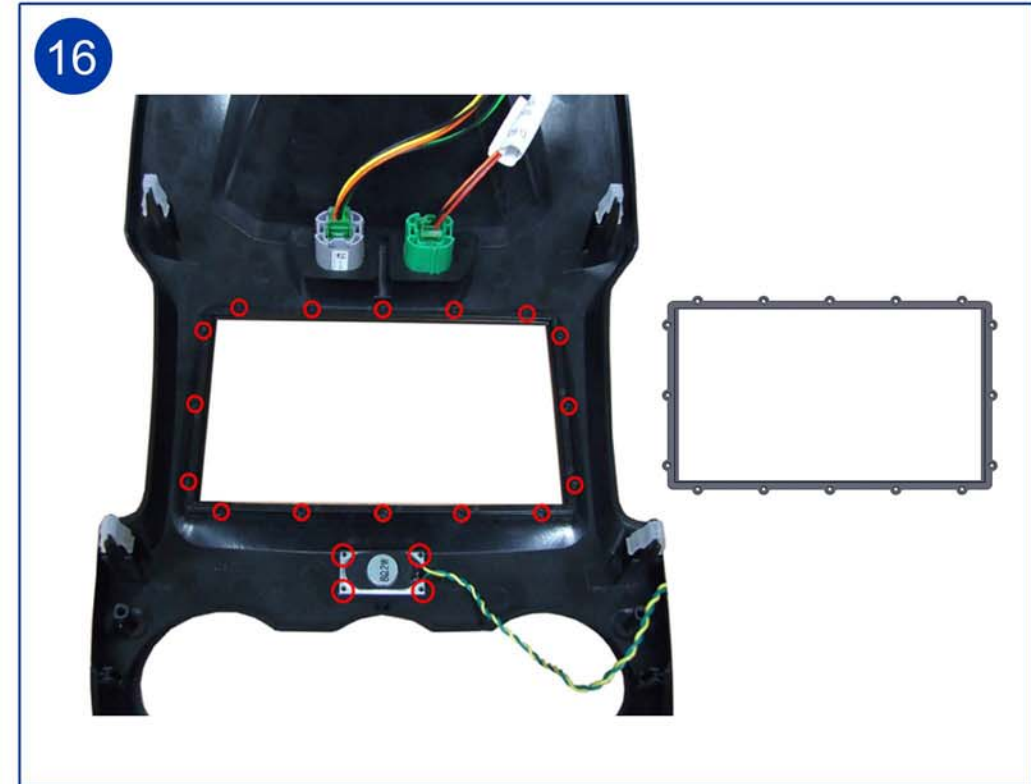

16

**14** Tuck and hide away the stalk interface box

Remove clips from Connects2 fascia  
Fit stereo brackets - Dont fully tighten  
Fit stereo into dash - Test fit  
Test fit fascia - manipulated stereo into final position

**15** Remove fascia  
Remove stereo - Being careful not to move the brackets  
Fully tighten stereo brackets  
Re-fit stereo  
Re-fit fascia clips

Place the speaker onto the Connects2 fascia and with a soldering iron, melt the four plastic tabs (highlighted in the picture) in the corner of the speaker.

**16**

Try the supplied trim around the face of the head unit first before melting into place (highlighted in the picture). If the trim does not fit around face of head unit then trim is not needed

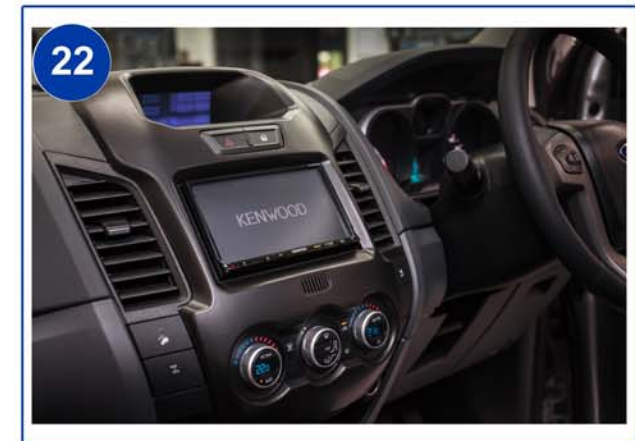
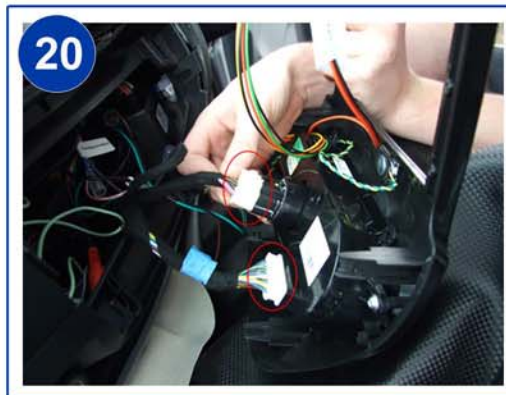
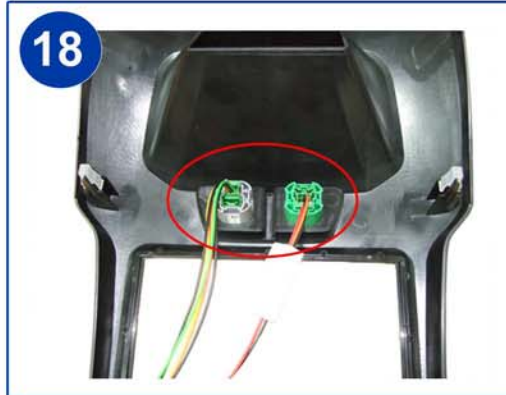

**17** Connect up the mini speaker connector

**18** Plug the Connects2 cable into the Hazard and door lock switch connectors at the top of the fascia (Grey switch first)

**19** Connect the other end of the switch connector cable onto the vehicles harness. Also connect the Kenwood and ISO head unit harnesses.

**20** Reconnect the heater controls

**21** Unclip switch wire from switches and feed the switch connector wires around the head unit and tidy up the wiring behind the heater controls to allow the fascia to clip into place correctly

**22** Finally fit the fascia into place and the install is complete

# Installation Guide

Part No: CTSFO008.2

Ford Can-Bus Steering Wheel Control Interface

Technical support provided by,



P: 03 9847 0177

E: solutions@stinger australia.com.au

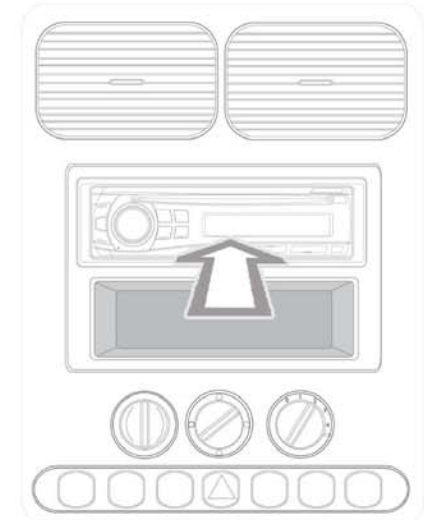
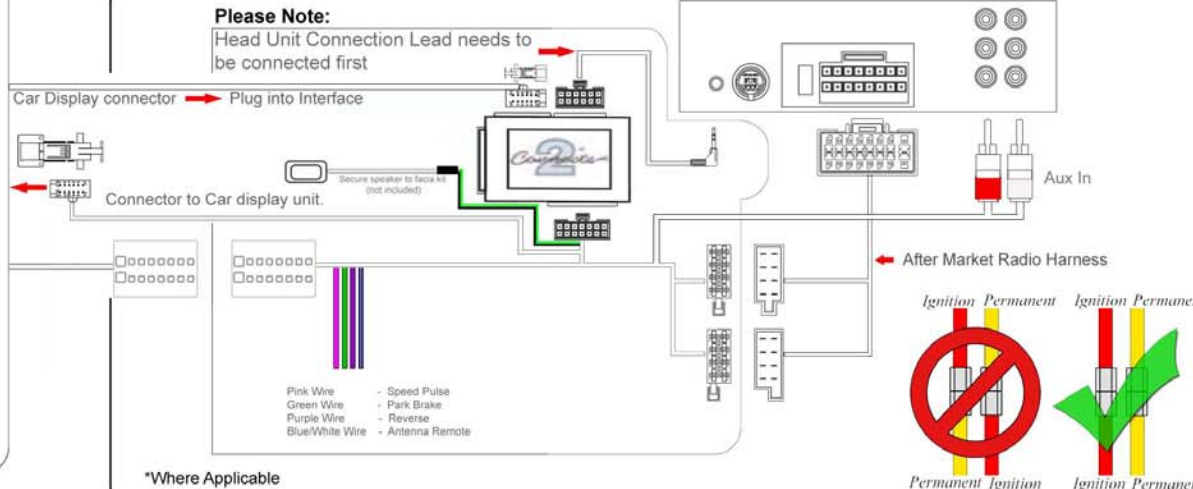
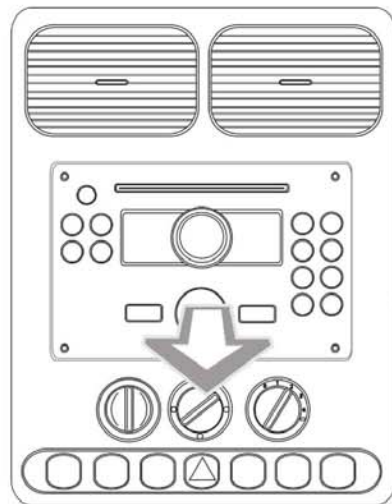

## Vehicle Compatibility:

Ford Ranger 2012-15

## Steering Wheel Control Functions



### \*Note

- All dates are guide lines only as specifications of vehicles change.
- To retain phone button functions, PACSWICP2 is required.

# Installation Guide

Part No: CTSFO008.2

Ford Can-Bus Steering Wheel Control Interface

## User guide to change the time and date



- 1 - Speech Button
- 2 - Select Right
- 3 - Select up
- 4 - Select left
- 5 - Select down

Single Press (**Button 1**) switches display on .  
Press & Hold **Speech Button (button 1)** for 2 seconds  
this will enable menu mode option.

Press (**Buttons 3/5**) Up/down till clock setting is selected.  
Then press (**Button 1**) to confirm.

To Adjust the clock use (**Buttons 3/5**),select the next  
option use (**Buttons 2/4**).and then press (**Button 1**) to confirm.

Press (**Buttons 3/5**) Up/down till set date is selected  
Then press (**Button 1**), to confirm.

To adjust the date use (**Buttons 3/5**) And to select the next  
option use (**Buttons 2/4**) .press (**Button 1**) to confirm.

When the time and date has been set,  
Press the **speech button(Button 1)** once to confirm.

**The menu option will time out after 15-20 seconds.**

